

PROXXON

DS 460

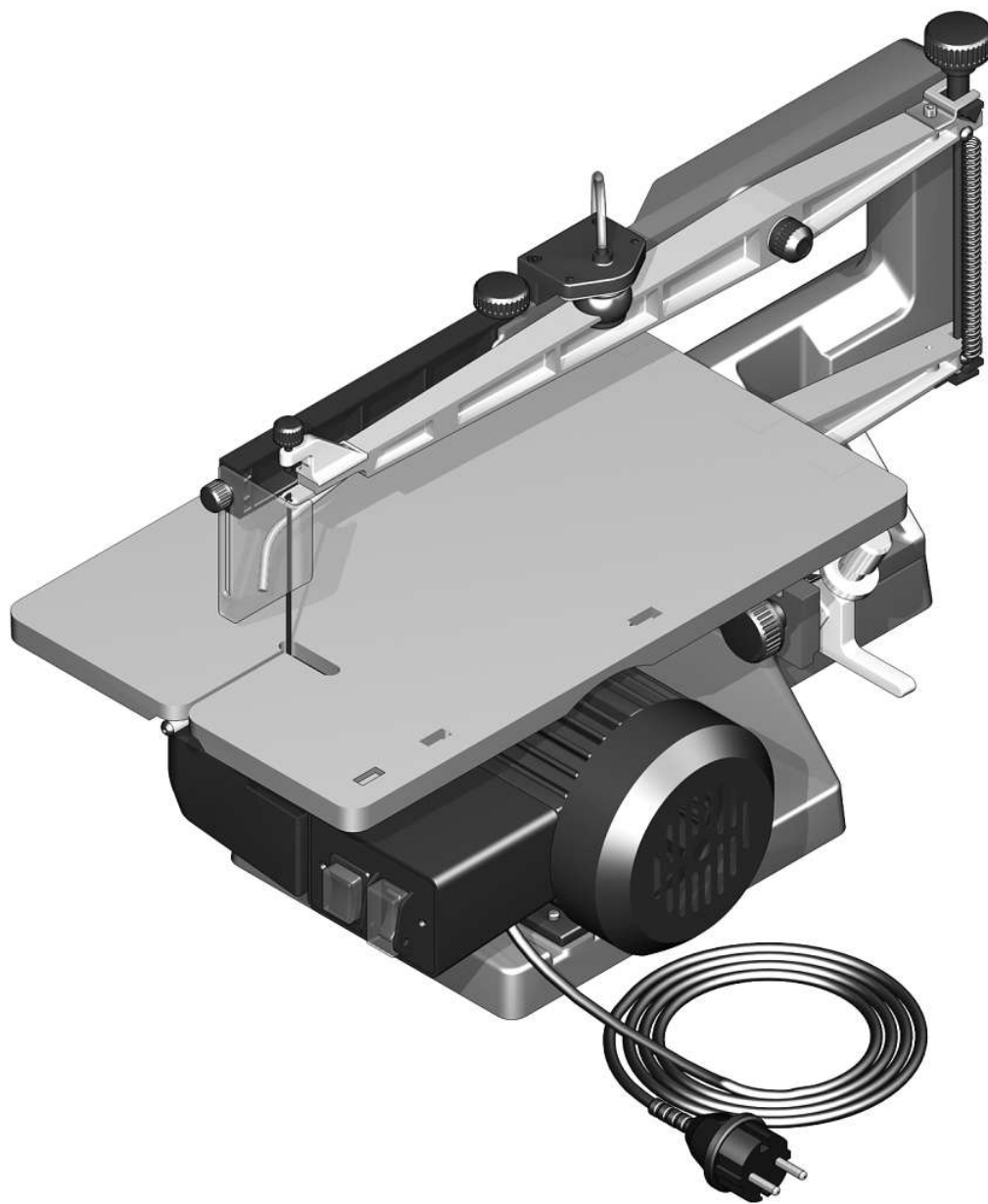

Manual

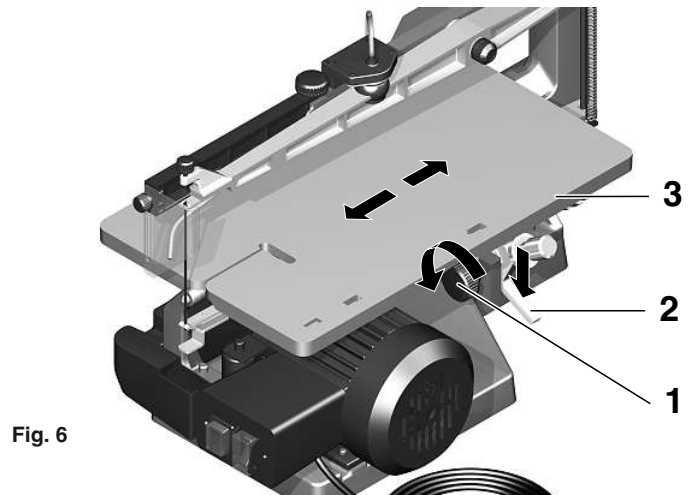
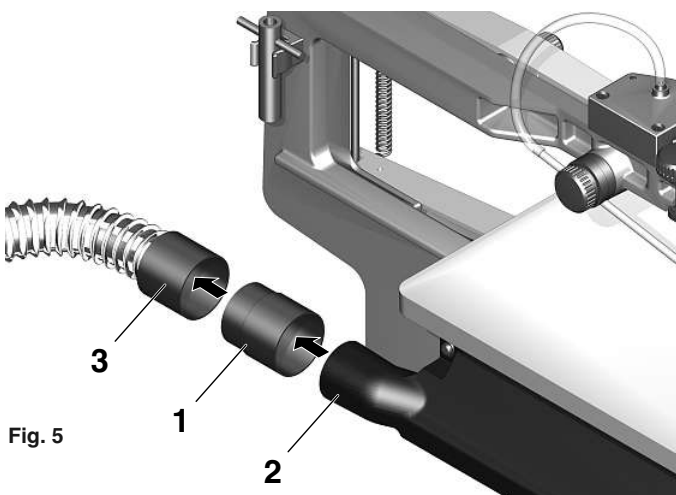
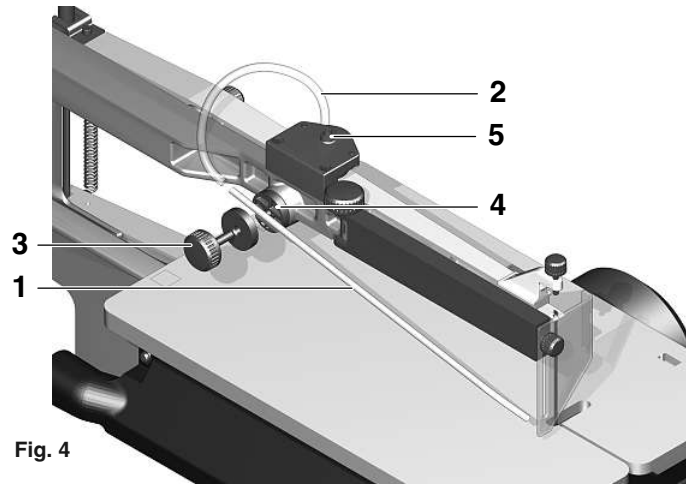
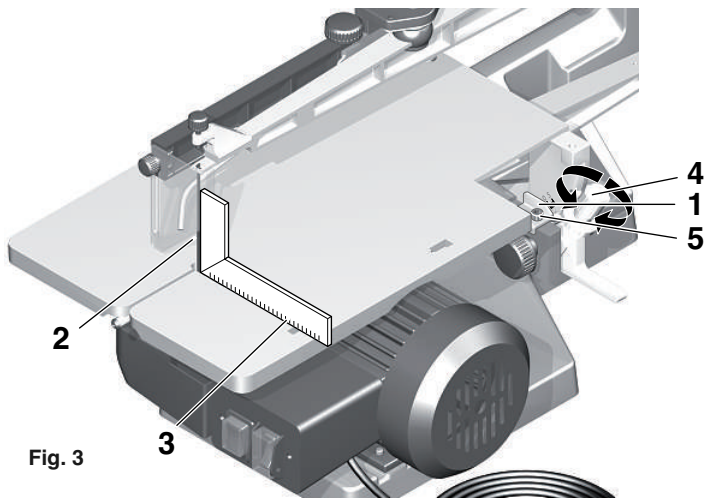
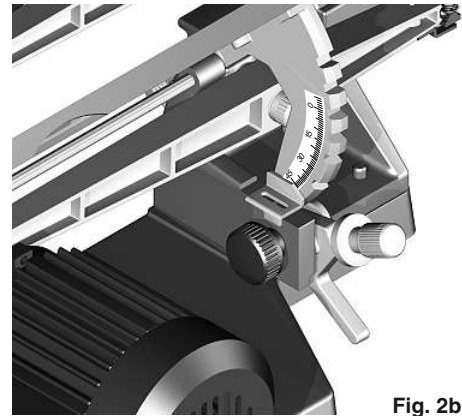
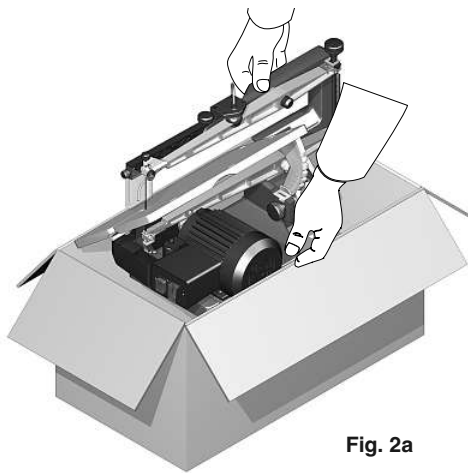
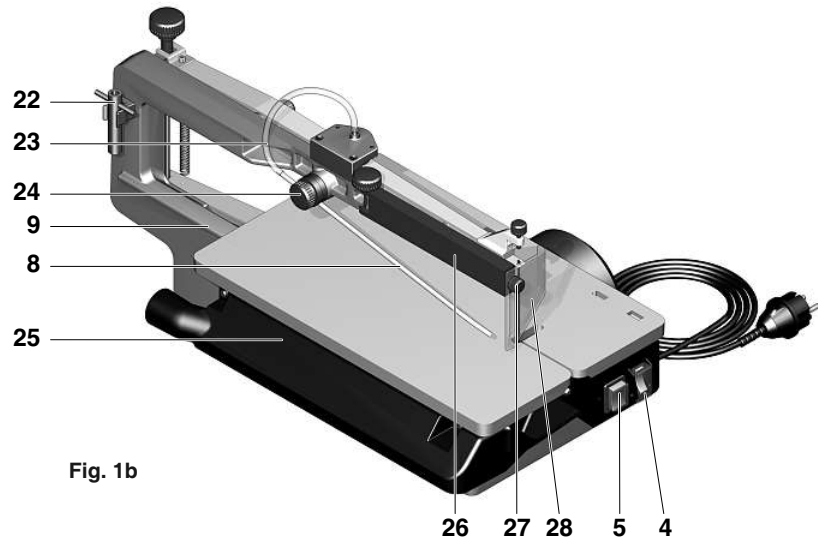
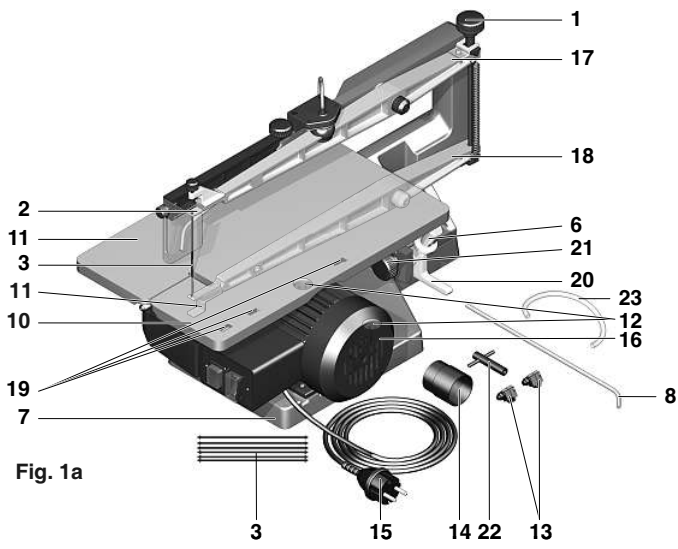

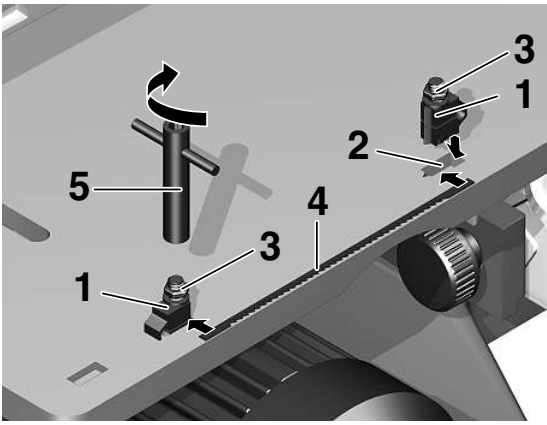

Fig. 7a

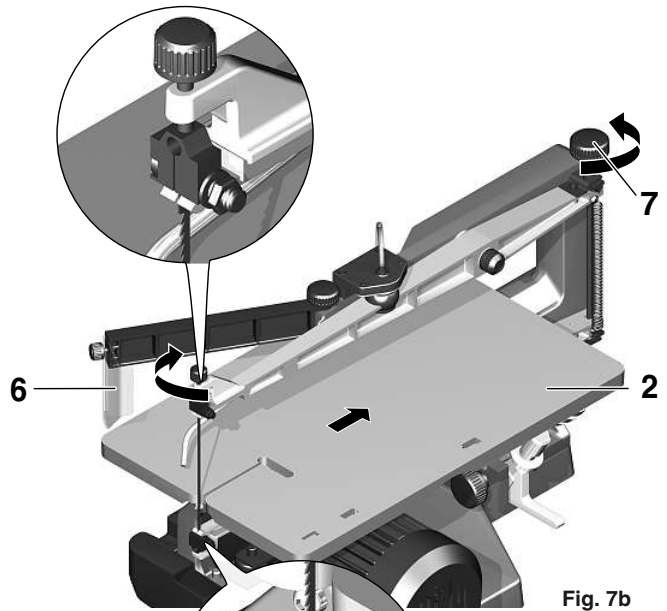

Fig. 7b

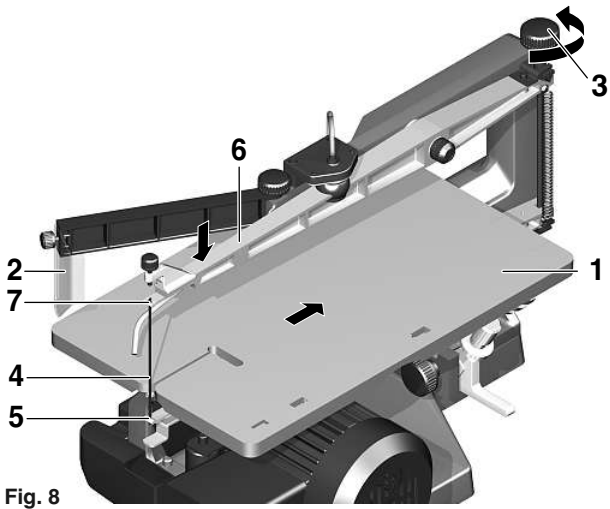

Fig. 8

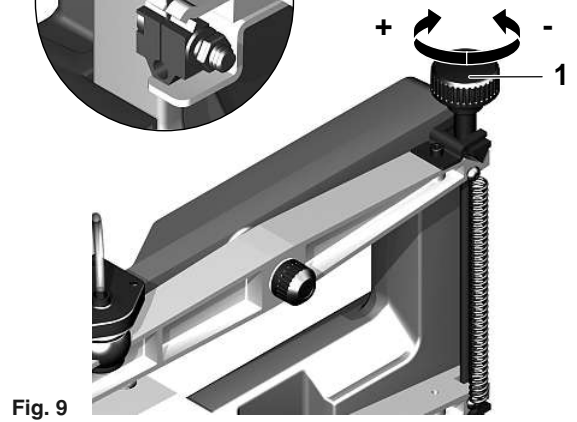

Fig. 9

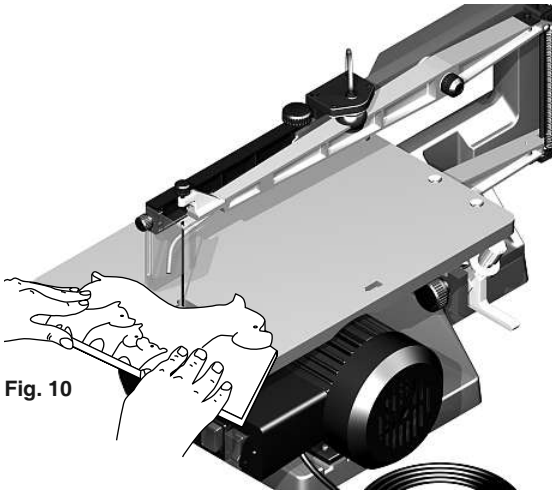

Fig. 10

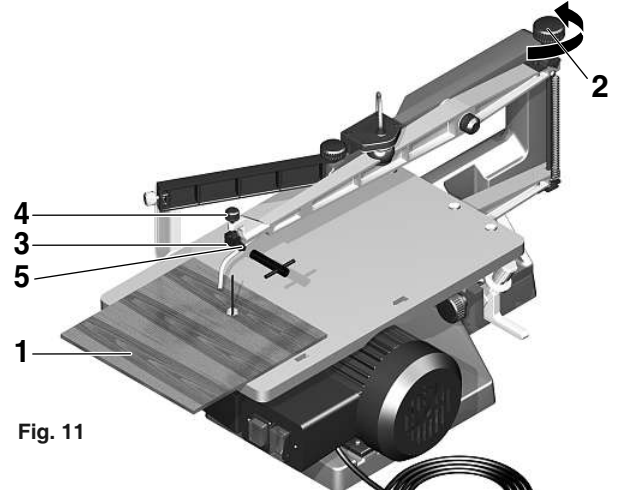

Fig. 11

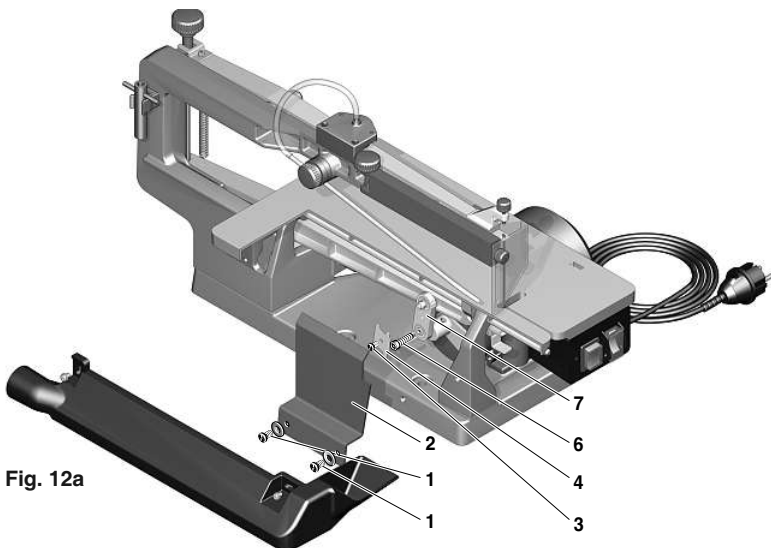

Fig. 12a

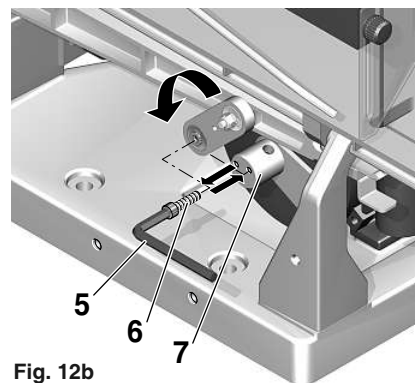

Fig. 12b

Contents:

1	Scroll Saw DS 460:	12
2	General Safety Information	12
3	Legend (Fig. 1)	13
4	Description of the Machine (see also fig. 1a and 1b)	13
5	Technical Data:	13
6	Installation and Commissioning of the Saw	14
6.1	Unpacking (Fig. 2a and 2b):	14
6.2	Installing the Saw	14
6.3	Adjusting the Angle Display (Fig. 3):	14
6.4	Assembling the Air Nozzle (Fig. 4):	14
6.5	Connecting the Vacuum Cleaner (Fig. 5):.....	14
6.6	Saw Blades	14
6.6.1	Clamping and Changing the Saw Blade	14
6.6.1.1	Pushing the Saw Table Back or into the Working Position (Fig. 6)	14
6.6.1.2	Saw Blades with Flat Ends (Hand and Fret Saw Blades) (Fig. 7a and 7b):	15
6.6.2	Saw Blades with Pin Ends (Fig. 8):	15
6.6.3	Fine Setting of the Correct Saw Tension (Fig. 9):	15
7	Working with the Saw:	15
7.1	General Information for Working with the Scroll Saw	15
7.1.1	Choice of Saw Blade	15
7.1.2	Selecting the Speed:	16
7.1.3	Possible Causes of Broken Saw Blades:	16
7.2	Sawing (Fig. 10)	16
7.2.1	Inside Cuts (Fig. 11)	16
7.2.2	Mitre Cuts (Fig. 2b)	16
7.2.2.1	Setting the Mitre Angle.....	16
7.2.2.2	Fine Setting (Fig. 2b)	16
7.2.2.3	Setting the saw blade stroke (fig. 12 a and 12 b)	16
8	Maintenance and Repairs	17
9	Cleaning and Care:	17
10	Disposal	17
11	CE Declaration:	17
12	Spare Parts List.....	78
13	Exploded Drawing.....	79

1 Scroll Saw DS 460:

Dear customer!

The use of these instructions

- makes it easier to become acquainted with the device,
- prevents malfunctions due to improper handling, and
- increases the service life of your device.

Always keep these instructions close to hand.

Only operate this device with exact knowledge of it and comply with the instructions.

PROXXON will not be liable for the safe function of the device for:

- handling that does not comply with the usual intended use,
- other application uses that are not stated in the instructions,
- disregard of the safety regulations,

You will not have any warranty claims for:

- operating errors,
- lack of maintenance.

For your safety, please comply with the safety regulations without fail.

Only use original PROXXON spare parts.

All rights reserved for further developments in the course of technical progress. We wish you much success with the device.

2 General Safety Information

CAUTION! When using electric power tools, the following safety measures must be observed for protection from electric shock, risk of injury, and fire hazards.

Read and take note of all these instructions before you start up the product. Keep these safety instructions in a safe place.

Safe working

Always keep your working area tidy.

1. Disorder in the working area can lead to accidents.

Take account of surrounding influences.

1. Do not expose tools to the rain.
2. Do not use tools in damp or wet surroundings.
3. Ensure that the lighting is good.
4. Do not use tools in the vicinity of combustible liquids or gases.

Protect yourself from electric shocks.

1. Avoid body parts from coming into contact with earthed parts.

Keep other people away.

1. Do not let other people, especially children, touch the tool or the cable. Keep them well away from the working area.

Keep unused tools in a safe place.

1. Unused equipment should be kept in a dry, closed location out of the reach of children.

Do not overload your tool.

1. You will be able to work better and safer within the given power range.

Always use the correct tool.

1. Do not use low power machines for heavy work.
2. Do not use tools for purposes for which they were not designed. For example do not use manually-operated circular saws for cutting branches or firewood.

Wear suitable working clothing.

1. Do not wear loose clothing or jewellery, they can get caught up by moving parts.
2. When working in the open air we recommend the use of non-slip footwear.
3. Wear a hair net if you have long hair.

Use the protective equipment.

1. Wear safety glasses.
2. Wear a breathing mask when carrying out dust-generating work.

Connect to the dust extraction equipment.

1. If connections are available to dust extraction and collection equipment, make sure that they are properly connected and used.

Do not use the cable for purposes for which it was not designed.

1. Do not use the cable to pull the plug out of its socket. Protect the cable from heat, oil and sharp edges.

Secure the tool.

1. Use the clamping fixture or a vice to hold the tool tightly. It is thus held more safely than with your hand.

Avoid abnormal postures.

1. Ensure that you are standing safely and always maintain your balance.

Take great care of your tools.

1. Keep the tools sharp and clean so as to be able to work better and safer.
2. Follow the maintenance instructions and the advice about tool changing.

3. Regularly check the tool cable and have it replaced by an authorized specialist if it is damaged.
4. Regularly check the extension cables and replace them if they are damaged.
5. Keep handles dry and free from oil and grease.

Pull the plug out of the socket:

1. When the tool is not in use, before maintenance and when changing tools such as the saw blade, drill or milling cutters, always take the plug out of the socket.

Do not leave any tool spanners or setting keys in place.

1. Before switching on always check that spanners, keys and setting tools have been removed.

Avoid unintentional starting.

1. Always make sure that the switch is in the OFF position when you plug the tool into the socket.

Extension cables in the open air.

1. In the open air always use extension cables which are authorized for the purpose and which are correspondingly marked.

Always be attentive.

1. Be aware of what you are doing. Carry out your work sensibly. Do not use the tool if you are tired.

Check the tool for damage.

1. Before further use of the tool, examine protective devices or slightly-damaged parts to ensure that the function is perfect and meets the requirements.
2. Check that the moving parts function perfectly and do not stick and that parts are not damaged. All parts must be correctly mounted and all the conditions fulfilled to ensure trouble-free tool operation.
3. Damaged protective equipment and parts must be properly repaired or exchanged by an authorized specialist workshop if no other information is given in the instructions for use.
4. Arrange for damaged switches to be exchanged by a customer services workshop.
5. Never use tools on which the switch cannot be switched on and off.

WARNING!

1. The use of other tool inserts and accessories can present a risk of injury.

Arrange for your tool to be repaired by a specialist electrician

1. This tool meets the relevant safety regulations. Repairs may only be carried out by electrical specialists and original spare parts must be used. Otherwise accidents can happen to the user.

3 Legend (Fig. 1)

1. Adjusting knob for saw blade tension
2. Saw blade holder, top
3. Saw blade
4. ON - OFF switch
5. Adjusting knob for number of strokes
6. Screw for fine setting of the work table's angle of rotation
7. Die-cast steel pedestal
8. Air nozzle
9. Die-cast steel machine body
10. Rotatable saw table
11. Saw blade holder, bottom
12. Holes for fastening screws
13. Slide blocks for clamping the saw blade
14. Rubber connecting piece for vacuum cleaner connection
15. Mains cable
16. Induction motor
17. Saw arm (top)
18. Saw arm (bottom)
19. Recesses for the slide blocks
20. Lock lever
21. Clamping screw for lock lever
22. T-handle key
23. Hose

24. Clamping screw for air nozzle alignment
25. Dust suction connection
26. Arm for saw blade guard
27. Clamping screw for saw blade guard
28. Saw blade guard

4 Description of the Machine (see also fig. 1a and 1b)

The PROXXON scroll saw is a very sturdy, ruggedly designed but nevertheless mechanically very sophisticated and carefully produced device. The heavy die-cast pedestal and the rigid die-cast machine body form a solid base for the complex machine mechanics and a perfect platform for the precision mounting of the saw arms which are made of ultra-light but strong magnesium in order to reduce the moved weights. They are driven by a quiet, powerful induction motor which can be adapted to the required material properties with two speeds (900/1400 rpm) for optimum smooth running and low vibration.

Your DS 460 has many areas of application and is particularly suitable for mould construction, fine mechanics, model building and toy manufacture. It is therefore just the right tool for ambitious model builders, designers, architects (model building) or carpenters.

The large tiltable saw table for mitre cuts of -5 to 50° is made of die-cast aluminium for maximum accuracy and stability and precision ground for optimum gliding characteristics. Its special design also simplifies changing of the saw blade.

The saw table can be unlocked and pushed back to improve the accessibility of the lower saw blade attachment. This enables quick and easy changing of the saw blades.

Saw blades with both pin ends and flat ends can be used. The use of sliding blocks allows precise guiding of the saw blade without interference from bending forces.

You will find the appropriate saw blades for the respective job in the Proxxon range of accessories. We recommend you to use Proxxon saw blades exclusively!

The DS 460 saws soft wood up to a thickness of 50 mm, plastic up to 30 mm and non-ferrous metals up to 10 mm.

The saw can also be used to easily cut plexiglass, GRP, foam, rubber, leather and cork.

And there is an automatically driven bellows with an adjustable air nozzle to ensure that dust does not obstruct the view of the cutting line during work.

A vacuum cleaner can be connected additionally. This guarantees clean working.

5 Technical Data:

Number of strokes:	900 or 1,400/min
Lifting height:	18 mm
Max. cutting depth: (in wood) at 45°:	60 mm 35 mm
Saw blade length:	127 mm (with pin end) 125-130 mm (without pin end)
Noise development:	< 70 dB(A)
Vibration	< 2.5 m/s
Weight:	approx. 20 kg

Dimensions:

LxWxH	580 x 320 x 300 (in mm, approx. data)
Table:	400 x 250 mm
Throat:	460 mm

Motor:

Voltage:	220/240 V, 50/60 Hz
Power input:	145/205 W

6 Installation and Commissioning of the Saw

Caution:

Make sure your mains plug has a protective earthing conductor and is suitable to operate the device!

6.1 Unpacking (Fig. 2a and 2b):

1. Take the device carefully out of the box. Please hold the scroll saw by the die-cast housing as shown in fig. 2a. This will avoid damage.
2. The saw table 1 is folded up at an angle of about 45° for transport reasons. Please loosen the clamping screw 2 (fig. 2b), pull down the lock lever of the angle adjustment, move the table into the horizontal position and snap the lock lever back into the gear 4.

6.2 Installing the Saw

N.B.:

Safe and accurate work is only possible with careful fastening!

1. Fix the saw to a strong workbench with two screws (Ø 8 mm, not included). Use the holes (12, fig. 1) on the right and left in the pedestal.

6.3 Adjusting the Angle Display (Fig. 3):

Caution:

Make sure that the mains plug is removed before doing any setting work, otherwise there is a danger of injury in case of accidental starting of the machine!

The angle display 1 is set exactly at the factory and does not normally need to be readjusted. If it has become misadjusted, this is quite easy to correct:

1. Clamp the saw blade 2. See the relevant section of this manual.
2. Set the saw table to the "0°" position. See the section "Mitre Cuts". This tells you how to set the angle of the saw table.
3. Check using a square 3 whether the saw blade actually is at a right angle to the saw table in this position. If not, readjust the saw table setting at the knurled screw 4.
4. Check the position in the angle display 1. This must now be aligned exactly to the 0° position on the scale.
5. If the angle display needs to be adjusted, loosen the Allen screw 5, move the angle display to the 0° position and retighten the Allen screw.
6. Test by sawing a piece of wood and check the angle on the work-piece again.

6.4 Assembling the Air Nozzle (Fig. 4):

Sawdust along the cutting line is removed immediately by a blower during work. Ideal for a free view. The blower starts automatically as soon as the saw is switched on.

1. Remove the air nozzle pipe 1 and hose 2 from the enclosed bag.
2. Loosen the knurled screw 3 and insert the air nozzle pipe 1 into the appropriate recess in the open clamping pieces 4.
3. Align the air nozzle pipe and tighten the knurled screw 3.
4. Push the air hose 2 onto the rear end of the air nozzle pipe 1 and the nipple 5 on the bellows on the top saw arm.

To align the air nozzle, simply loosen the knurled screw 3 and position the air nozzle pipe by turning and moving it towards the workpiece.

6.5 Connecting the Vacuum Cleaner (Fig. 5):

Caution:

Saw dust from certain materials can be hazardous to your health if inhaled or if it touches your skin. For that reason, always wear appropriate protective clothing (e.g. respirator) and always work with the suction device.

Danger: Dust in certain concentrations can generate an explosive mixture in the air!

1. Push the rubber connector 1 onto the connecting piece 2.
2. Push the vacuum cleaner hose 3 onto the rubber connector 1.
3. Switch on the vacuum cleaner before sawing so that the sawdust is sucked off and the suction device is not blocked.

Another small tip:

When using the Proxxon CW-matic vacuum cleaner, manual switching on and off is no longer necessary. The CW-matic is equipped with an automatic control that switches on and off automatically whenever the electrical tool is activated or deactivated. You have the same effect with commercially available vacuum cleaners when using our AS/E vacuum cleaner controller.

6.6 Saw Blades

Caution:

Always pull out the mains plug for all the activities described here.

Only use suitable saw blades. Make sure that the saw blades are suitable for use with the DS 460. You must comply with the dimensions specified in the technical data.

Please make sure that the saw blade is in perfect condition and change damaged or worn saw blades immediately! Deformed or damaged saw blades are dangerous to work with and may not be used! They also produce poor work results: Full sawing performance and precision can only be achieved with perfect saw blades.

We recommend the use of original PROXXON saw blades!

Choose the suitable saw blades carefully and for the respective application and material to be sawn.

Proxxon supplies different fine teeth, flat and round blades and blades with and without pin ends. You will find our range of blades in the Micromot catalogue or on the Internet under www.proxxon.com.

6.6.1 Clamping and Changing the Saw Blade

Both conventional saw blades with pin ends and hand (fret) saw blades without pin ends can be used. The saw table can be pushed back for optimum accessibility of the saw blade holder so that changing the saw blades is child's play.

Caution:

Please note that the saw blade guard can be folded away to change the saw blades.

6.6.1.1 Pushing the Saw Table Back or into the Working Position (Fig. 6)

Caution:

Please note that the saw table can only be pushed back when the saw table is in the 0° position, i.e. horizontal.

1. Release clamping screw 1 (fig. 6) of the lock lever 2.
2. Move down the lock lever and push the saw table 3 back.
3. Pull the saw table 3 forward after attaching the saw blade. The lock lever is actuated automatically in the front end position and locks the saw table.

6.6.1.2 Saw Blades with Flat Ends (Hand and Fret Saw Blades) (Fig. 7a and 7b):

The concept of the DS 460 is not designed like conventional scroll saws to simply clamp the blades in the saw blade holders at the ends of the saw arms. This conventional clamping method inevitably leads to fluctuating bending forces in the saw blade when the saw arms move up and down because the pendulum movement cannot be compensated. These cause heavy wear, the saw blade can break sooner.

Frequent blade changing is not to everyone's liking either. We have designed the clamping method with sliding blocks for all those who do

not want to do without the more accurate guiding of the blades with flat ends (unlike those with pin ends) but do not want their disadvantages. There is no lateral twisting in the attachment yet the blades can still follow the up and down movements of the saw arms freely without being exposed to bending forces.

1. Place the sliding blocks 1 (fig. 7a) in the openings provided in the saw table 2. The right clamping length is defined immediately. Caution: The clamping nuts 3 must be loosened and facing upwards! The sliding blocks must be inserted so that the pointed ends are facing each other, i.e. inwards.
2. Insert the saw blade in the centre of the clamping slit and tighten the clamping nuts with the Allen key 5 provided. Caution: The saw blade must be inserted the same distance into the clamping slit on both sliding blocks.
3. Push back the saw table 2 as described above and fold away the saw blade guard 6 if necessary.
4. Turn the knob 7 to the left to loosen the tension on the saw blade.
5. Remove the saw blade if necessary and insert a new saw blade 4 with the sliding blocks into the saw blade holders as shown in fig. 7b. Slight pressure can be applied to the top arm as required or the blade tension can be loosened further on the knob 7 if necessary. Caution: The teeth of the blade must face downwards!
6. Pull the table forward again as described above.
7. Regulate the saw blade tension as described in the section "Fine Setting of the Correct Saw Tension".

6.6.2 Swa Blades with Pin Ends (Fig. 8):

Saw blades with pin ends are very suitable for working with many closed inside cuts. Here, the saw blade can be taken quickly and conveniently out of the top holder, looped through the workpiece and reattached. Details can be found in the "Inside Cuts" section. But be careful: The precision of the guiding with pin end blades is inferior to that of saw blades with flat ends and sliding blocks. Absolute precision in the guiding of the cut can only be achieved with these.

1. Push back the saw table 1 as described above and fold away the saw blade guard 2 if necessary.
2. Turn the knob 3 to the left to loosen the tension on the saw blade.
3. Remove a saw blade already in the holder and fit the saw blade 4 with the teeth facing downwards into the bottom holder 5.
4. Press the top arm 6 lightly if necessary and attach a new saw blade to the top holder 7. Loosen the saw blade tension further with the knob 3 if necessary.
5. Release the arm after attaching the blade and set the blade tension with the knob 3.
6. Regulate the saw blade tension as described in the section "Fine Setting of the Correct Saw Tension".

6.6.3 Fine Setting of the Correct Saw Tension (Fig. 9):

The right saw tension is decisive for a good work result. It must therefore be set carefully. The saw blade can also break if it is too tight or too slack.

Please turn the knob 1 (fig. 9) to set the tension. The saw blade is tightened by turning the knob to the right (clockwise) and loosened by turning it to the left (anticlockwise).

A correctly tensioned blade emits a high tone when "plucked".

7 Working with the Saw:

7.1 General Information for Working with the Scroll Saw

The scroll saw is primarily a machine for sawing curves and precise cut-outs. A typical application is shown in fig. 10. The operator must move the workpiece carefully for this. N.B.: Scroll saws are usually operated without a longitudinal stop because the saw blade "wanders" when it is guided "by force" against a stop, especially in the grain of wood.

Please note that the saw blade only saws in the downward movement in the direction in which the teeth are facing.

For good results, please note the following points:

- Press the workpiece against the worktop when sawing; guide gently with little force; more pressure on the worktop, less pressure on the saw blade.
- Make sure that the workpiece is lying firmly on the saw table (no burr or chips).
- Adapt the movement to the requirements of the saw blade, speed and material of the workpiece.
- Move the workpiece into the saw blade slowly especially if the blade is very thin and the teeth very fine or the workpiece is very thick. N.B.: The teeth only saw in the downward movement!
- Only use perfect saw blades!
- Do not leave the device unattended!
- Draw/mark the guide line carefully.
- Provide good lighting conditions!
- Always work with connected dust exhaust and align the air nozzle carefully (see also "Assembling the Air Nozzle").
- The best results are achieved with a wood thickness of less than 25 mm.
- For wood thicknesses greater than 25 mm, you have to guide the workpiece very carefully to avoid jamming, bending, twisting and snapping of the saw blade.
- For exact cuts in wood please bear in mind that the saw blade will always try to follow the grain (applies especially for thin saw blades).
- When sawing round materials, please bear in mind that these could turn with the movement of the saw band and therefore must be held particularly tightly! Please use a suitable holding device for the workpiece if necessary!

7.1.1 Choice of Saw Blade

As already mentioned, the right choice of blade for the material has a great influence on the quality of the result. The table below serves for orientation. Of course, a wide experience with many different types of materials and saw blades is always helpful, too. It is worth experimenting a little!

A tip: The saw blades are usually only heavily worn in the place where the teeth are most stressed and therefore get blunt quickly. To "use up" the teeth which are not worn and thus prolong the life of the saw blades, the contact surface for the workpiece can be "raised" slightly artificially.

Simply fix a smooth underlay of the appropriate thickness and same size of the table to the saw table with double-sided adhesive tape for example. The parts of the saw blade which are not worn now saw into the workpiece.

This is particularly useful when sawing very hard and therefore very wearing materials frequently with fine blades.

The figures for characterising the "fineness" of the teeth refer to the number of teeth per inch of the saw blade length:

Teeth/inch	Material:
approx. 10-14	soft and hard wood (approx. 6- 50 mm), plastics, softer materials, thicker workpieces
approx. 17-18	finer sawing work, wood (up to approx. 6 mm), plastics, softer materials, thinner workpieces
approx. 25-28	plastic, GRP, non-ferrous metal, plexiglass, iron, FR-2 with restrictions
approx. 41	iron, FR-2

Round saw blades (with flat ends) are ideal for use with plastic, hard and soft wood. They cut on all sides so there is no need to turn the workpiece when sawing.

Our full range of suitable saw blades for your DS 460 can be found in our Micromot catalogue or on the Internet under www.proxxon.com.

7.1.2 Selecting the Speed:

This description can of course only give a guideline for the option to be taken. As in the previous section, you have to do a little “experimenting” to find the optimum result. The right speed also depends on the blade used, the workpiece material, feed etc. of course.

Speed	Material
900 strokes/min	Steel, brass, non-ferrous metals, GRP, plastics
1,400 strokes/min	aluminium, wood, polystyrene, rubber, leather, cork

7.1.3 Possible Causes of Broken Saw Blades:

The saw blade can break for the following reasons:

- blade tension too high or too low
- mechanical overloading of the blade by moving too quickly
- bending or twisting of the blade when turning the workpiece too quickly to cut curves
- when the wear limit of the saw blade is reached
- when the screws are tightened with saw blades with pin ends

7.2 Sawing (Fig. 10)

Please hold the workpiece on the saw table as shown in fig. 10. Adapt the feeding to the material, the saw blade and the thickness of the workpiece! Hard materials, fine saw blades and thicker workpieces do not “stand” as must thrust as softer materials, coarser saw blades and thin workpieces.

Try out results at different speeds.

N.B.:

Safe and accurate work is only possible with careful fastening!

The scroll saw is primarily a machine for sawing curves. For good results, please note the following points:

For your own safety please:

- Only use perfect saw blades!
- Always pull out the mains plug for maintenance and cleaning.
- Do not leave the device unattended.
- Always make sure that the saw blade guard is in the operating position as shown in fig. 10!

1. Press the workpiece against the worktop when sawing; guide gently with little force; more pressure on the worktop, less pressure on the saw blade. Caution: The saw does not cut the workpiece on its own. You have to move the workpiece into the saw blade.
2. Move the workpiece into the saw blade slowly especially if the blade is very thin and the teeth very fine or the workpiece is very thick. The best results are achieved with a wood thickness of less than 25 mm.

7.2.1 Inside Cuts (Fig. 11)

Caution:

Always pull out the mains plug before loosening the saw blade!

If you want to make inside cuts when working with your scroll saw, there are different ways to thread the saw blade through the opening in the workpiece.

If the inside cuts are big enough, the saw blade can be inserted with the sliding block, i.e. in the assembled state. However, finer inside cuts are also possible: To do this, the sliding block is clamped in the top holder, the saw blade loosened, inserted into the workpiece and re-clamped. When using saw blades with pin ends, these must be simply attached and detached after loosening the saw blade tension.

1. Drill a hole in the part of the workpiece to be cut out 1.
2. Loosen the saw blade tension by turning the knob 2.
3. Detach the saw blade with the sliding block or the pin end from the top saw blade holder 3 or

4. clamp the sliding block with the knurled screw 4, loosen the nut 5 and remove the saw blade.
5. Push the saw blade through the hole in the workpiece and reattach the sliding block or pin end or insert the saw blade in the sliding block and re-clamp with the nut 5. Loosen knurled screw 4!

Caution:

Please note that the knurled screw 4 must always be loosened in operation! The sliding block may not be clamped during operation but must swing freely!

6. Set the saw blade tension correctly with the knob 2.
7. Cut out the opening and remove the workpiece after detaching the saw blade again.

A tip:

If you drill the hole so that it does not touch the later inside contour, you can have the sawing line “run in” to the contour to be sawn out tangentially. This gives a nice even sawing edge.

If necessary, the lower of the recesses in the sawing table (fig. 1, item 19) can be used for fixing the sliding block if it is necessary to loosen the nut of the sliding block to remove the blade.

7.2.2 Mitre Cuts (Fig. 2b)

7.2.2.1 Setting the Mitre Angle

For mitre cuts, the table is simply tilted by the desired angle. This can be done quickly and easily with the angle adjustment of your DS 460.

1. Loosen the clamping screw 2.
2. Move the lock lever 3 down and tilt the saw table 1 to the desired angle.
3. Snap the lock lever into the appropriate recess of the angle scale 4 on the saw table.
4. Retighten the clamping screw 2.

Caution!

Please press the workpiece very firmly against the table to saw a mitre cut.

7.2.2.2 Fine Setting (Fig. 2b)

Please note:

The recesses in the angle scale are designed so that the most common mitre cuts can be selected quickly. Any intermediate setting can also be made of course. To do this, simply turn the knurled screw 5 when the lever is in a detent position. Please note: The clamping screw 2 can be left tight to make the setting!

7.2.2.3 Setting the saw blade stroke (fig. 12 a and 12 b)

The factory-set saw blade stroke of 18 mm represents the optimum for most applications and usually does not need to be changed. In rare cases, certain working conditions do not permit satisfactory working results, for example, if the saw blade speed is too high even at a low number of strokes (e.g., if sawing plastic and the material melts and welds back together). In this case, the DS 460 makes it possible to minimise the stroke which reduces the cutting speed.

1. Unscrew both screws from suction connection 8 and remove the suction connection
2. Unscrew both screws 1 and detach cover plate 4
3. Use the included Allen screw to unscrew screw 6 from the eccentric 7.
4. Screw in screw 6 to the second thread in the eccentric.
5. Screw plate 4 together with screw 3
6. Screw plate 2 together with both screws 1
7. Refasten the suction connection

8 Maintenance and Repairs

Caution:

Always pull out the mains plug before maintenance, cleaning and repairs.

The device is maintenance-free except for the necessity for regular cleaning (see below).

Repairs may only be carried out by qualified technical personnel or better still by the PROXXON Central Service! Never repair electrical parts but always replace them with original PROXXON spare parts!

9 Cleaning and Care:

Caution:

Always pull out the mains plug before maintenance, cleaning and repairs.

To ensure a long service life, the machine should be cleaned with a soft cloth, handbrush or paintbrush after each time it is used. A vacuum cleaner is also recommended here.

As already mentioned, you should always work with a dust suction device to prevent a high accumulation of dust in the first place.

The outside of the housing can be cleaned with a soft, possibly damp cloth. In this process, mild soap or another suitable cleaning agent can be used. Solvents or cleaning agents containing alcohol (e.g. petrol, cleaning alcohols etc.) should be avoided, since these can attack the plastic parts.

It is best to apply a drop of machine oil to moving parts occasionally. The arm bearings and the sliding/rotating axis of the saw table should be oiled at regular intervals.

10 Disposal

Please do not dispose of this machine in household refuse! The machine contains materials that can be recycled. If you have any questions about this, please contact your local recycling company or other relevant communal institutions.

11 EC Declaration of Conformity

Name and address:
PROXXON S.A.
6-10, Hårebjerg
L-6868 Wecker

Product designation: DS 460
Article No.: 27094

In sole responsibility, we declare that this product conforms to the following directives and normative documents:

EU EMC Directive	2004/108/EC
Applied standards:	DIN EN 55014-1 / 05.2012 DIN EN 55014-2 / 06.2009 DIN EN 61000-3-2 / 03.2010 DIN EN 61000-3-3 / 07.2012

EU Machinery Directive	2006/42/EC
Applied standards:	DIN EN 61029-1 / 01.2010

Date: 08.03.2013



Dipl.-Ing. Jörg Wagner

PROXXON S.A.
Machine Safety Department

The CE document authorized agent is identical with the signatory.

PROXXON DS460

ET- Nr.:	Description	ET- Nr.:	Description
27094-01	Motor	27094-61	Truss head screw
27094-02	Eccentric	27094-62	Bracket-tilt
27094-03	Screw	27094-63	Base
27094-04	Extension Spring	27094-64	Dust collector
27094-05	Round neck screw	27094-65	Round washer head screw
27094-06	Count head screw	27094-66	Label "Blade tensioning"
27094-07	Cover	27094-67	Brass tube
27094-08	Hex head bolt	27094-68	Clamp handle
27094-09	Compression spring	27094-69	Saddle
27094-10	Washer	27094-70	"Proxxon"-Label
27094-11	Clamp handle	27094-71	Round washer head screw
27094-12	Washer	27094-72	Chuck key seat
27094-13	Compression spring	27094-73	Handle collar
27094-14	Guide holder	27094-74	Body
27094-15	Blade holder	27094-75	Hex head screw
27094-16	Spring washer	27094-76	Sleeve
27094-17	Truss head screw	27094-77	Bellows seat
27094-18	Truss head screw	27094-78	Follower plate
27094-19	Blade holder	27094-79	Truss head tapping screw
27094-20	Retaining clip	27094-80	Bellows
27094-21	Hex nut	27094-81	Guide holder
27094-22	Holder blade (Assembly)	27094-82	Round neck screw
27094-23	Blade	27094-83	Tension handle
27094-24	Cap bolt	27094-84	Tilting scale seat
27094-25	Shaft sleeve	27094-85	Extension Spring
27094-26	Ball bearing	27094-86	Truss head screw
27094-27	Spring washer	27094-87	Flat washer
27094-28	Lock nut	27094-88	Pointer
27094-29	Pan head tapping screw	27094-89	Clamp handle
27094-30	Bearing protector	27094-90	Flat washer
27094-31	Hex head cap screw	27094-91	E-ring
27094-32	Connecting rod	27094-92	Location pin
27094-33	Washer	27094-93	Type label
27094-34	Truss head screw	27094-94	Sheet
27094-35	Flat washer	27094-95	Fastening screw
27094-36	Angle rod	27094-96	Capacitor
27094-37	Support	27094-97	Speed-Stage-Switch
27094-38	Hex head screw with washer	27094-98	On-Off-Switch
27094-39	Hex head cap screw	27094-99	Nut
27094-40	Spring washer	27094-100	Power cord
27094-41	Nut	27094-101	Hose
27094-42	Clamp bolster	27094-102	Allen key
27094-43	Lingage bar	27094-103	Guidance
27094-44	Bottom arm rocker (complete)	27094-104	Washer
27094-45	Upper arm rocker (complete)	27094-105	Socket screw
27094-46	Set plate	27094-106	Knurled screw
27094-47	Spring washer	27094-107	Washer
27094-48	Hex head cap screw	27094-108	Arm
27094-49	Clamp bolster	27094-109	Hex nut
27094-50	Spacer	27094-110	Cover
27094-51	Flat washer	27094-111	Washer
27094-52	Handle	27094-112	Knurled screw
27094-53	Blade guard (completely)	27094-113	Cap for speed-stage-switch
27094-54	Saw table	27094-114	Cap for on-off switch
27094-55	Set screw	27094-115	Motor cover
27094-56	Scale	27095-116	Switch box
27094-60	Flat washer	27096-117	Manual (not shown)

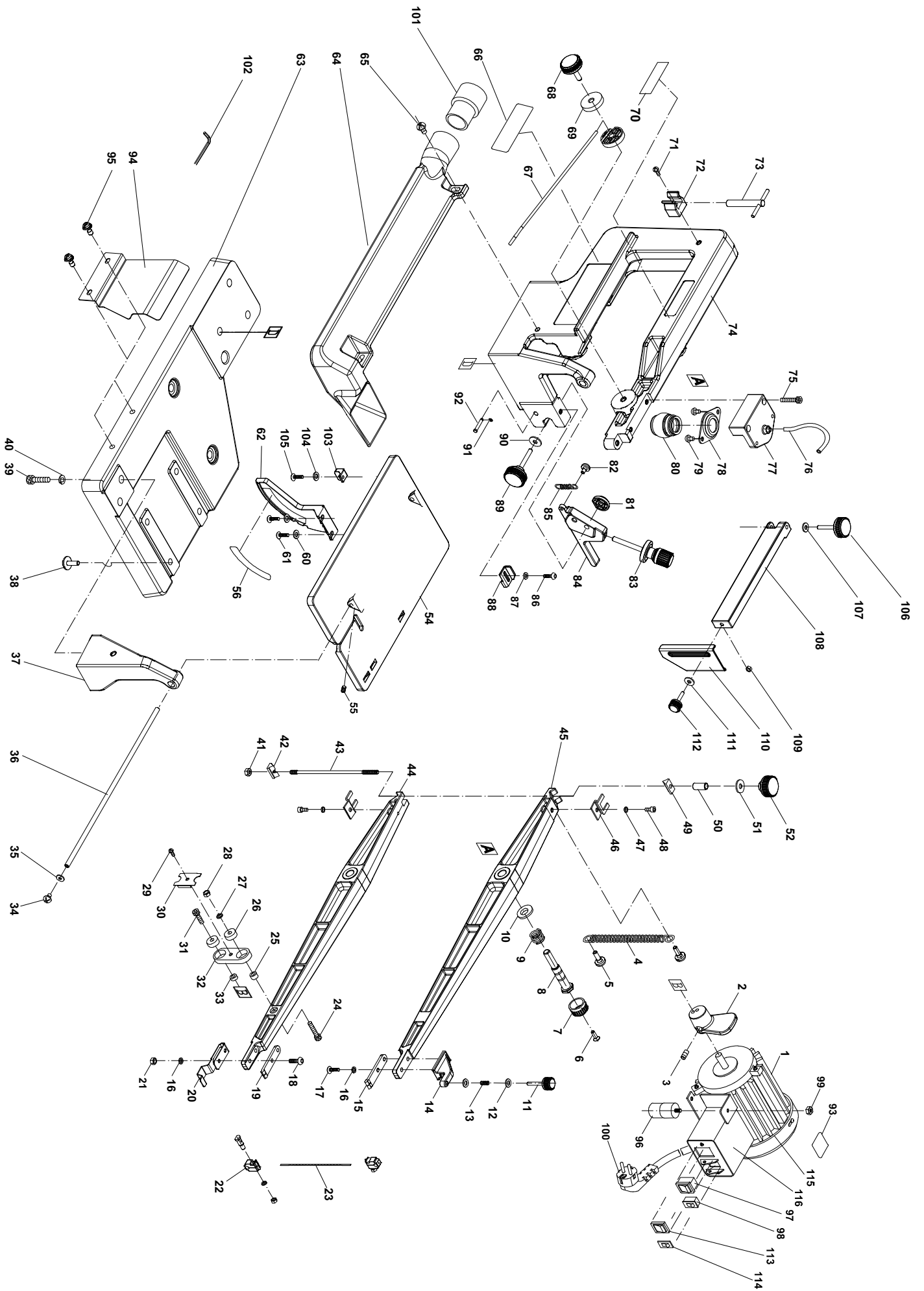

PROXXON

GB Service note

All PROXXON products are thoroughly inspected after production. Should a defect occur nevertheless, please contact the dealer from whom you purchased the product. Only the dealer is responsible for handling all legal warranty claims which refer exclusively to material and manufacturer error.

Improper use, such as capacity overload, damage due to outside influences and normal wear are excluded from the warranty.

You will find further notes for each country regarding "Service and Spare Parts Management" at www.proxxon.com.